



2265 Crosswind Dr., Prescott, AZ 86301
(928) 636-3175 www.p-a-g.net

8294

**Chevrolet, 4x4, Tahoe/Yukon
& Suburban/Yukon XL
Front part kit to update C994, C995 &
C996 Suspension kits to include the
2001 Vehicle Model Year**

THIS INSTRUCTION SHEET IS TO BE USED AS AN ADDENDUM TO THE INSTALLATION INSTRUCTION SHEET THAT WAS INCLUDED WITH THE FULL SUSPENSION KIT. THIS ADDENDUM SUPERCEDES ONLY ITS RELATED INFORMATION IN THE KIT MAIN INSTRUCTIONS. ALL OTHER INFORMATION IN THE MAIN INSTALLATION INSTRUCTIONS REMAINS VALID.



WARNING

Read and understand all instructions, warnings and cautions in these instructions, your owner's manual and related service manuals before the installation or use of this product.

Certain Trail Master products are intended to improve off-road performance. Modifying your vehicle for off-road use may result in the vehicle handling differently than a factory equipped vehicle. Use of oversize tires, suspension lifts, body lifts and other suspension modifications may raise your vehicle's center of gravity resulting in an increased tendency for the vehicle to pitch and roll during sudden turns or abrupt maneuvers. Extreme care must be used to prevent loss of control or vehicle roll over. Failure to drive your modified vehicle safely may result in serious injury or death. Drive at reduced speeds to ensure your ability to maintain control of the vehicle under all driving conditions. **Always** wear seat belts.

Trail Master does not recommend combined use of suspension lifts, body lifts or other lift devices. Combined use of lifts may result in unsafe and/or unexpected handling characteristics (See warning above). Many states now have laws restricting vehicle modifications such as lift, bumper height or other alterations. Consult local laws to determine if your proposed alterations (including installation of this kit) comply with your state laws.



CAUTION

1. Proper installation of Trail Master products requires knowledge of recommended procedures for disassembly/assembly of OE vehicles and components (i.e. steering tie rods, control arms, brake calipers, etc.). Access to OE shop manuals and special tools is required. Attempting to install this kit without knowledge of these procedures may affect the safety of your vehicle and/or the performance of these components. Trail Master strongly recommends that this kit be installed by a certified mechanic with off-road experience.
2. This kit is not recommended for trucks equipped with ABS brake systems or dual rear wheels. Use of this kit and/or larger tire and wheel combinations may reduce the effectiveness of the ABS braking system and increase the amount of pedal pressure necessary to obtain a given braking distance with normal stops and increase the stopping distance in a panic stop. Drive at reduced speeds and allow for extra stopping distance while driving a vehicle equipped with larger than OE tires. Discuss this issue with your tire and wheel dealer before installing larger tires and do not use tire and/or wheel combinations that compromise safe braking performance.
3. Refer to OE service manual for proper disassembly/assembly procedures for OE components (like steering shaft, anything else) **Consult following instructions for special tools necessary for this installation.**
4. Compare parts included in your system with the enclosed parts list. Placing hardware with components before you start may reduce installation time. Contact your Trail Master dealer if any parts are missing or appear to be different than those indicated on the parts list.
5. Trail Master recommends the use of loctite® on all hardware, unless noted otherwise.
6. Properly block and secure vehicle prior to installation.
7. **Always** wear safety glasses when using power tools.

NOTE

The parts contained in this kit are intended to update existing C994, C995 and C996 suspension kits (including SSV versions) to be able to include the 2001 model year of their applications.

This kit will update the C994 (& SSV) to the new C998 (& SSV) configuration.

This kit, when used with kit 8295, will update the C995 (& SSV) and C996 (& SSV) to the new C999 (& SSV) configuration.

SUMMARY OF REVISIONS

1. New design Trail Master relay rod and re-use of OE relay rod.
2. Added center support link for new relay rod.
3. Instructions for minor modifications to front skid plate.
4. Discard the outer tie rods ends (990103), inner tie rod ends (990102), tie rod tubes (CT10TRX) and the relay rod (980912) that were included in the main suspension kit.

INSTRUCTIONS

1. Follow the main suspension kit instructions up to the tie rod and relay rod disassembly steps.
Disconnect both OE tie rod ball joints from the OE knuckles per the Trail Master main suspension kit instructions. Remove the OE relay rod assembly (with the tie rods attached) from the pitman arm and idler arm.
2. Attach the OE relay rod assembly to the Trail Master relay rod per **Figure 1** using the 9/16 fasteners supplied in this kit (torque to 100 ft. lbs.). Make sure that the zerk fittings are facing down.



3. Modify the front skid plate (980902) from the main suspension kit per **Figure 2**.
 - A. Cut off tab just above weld per **Fig. 2**.
 - B. Drill one 1/2" hole as located per **Fig. 2**.
 - C. Remove any sharp edges resulting from this modification.
 - D. Protect the exposed raw edges from this modification with enamel touch-up paint.
4. Attach the modified skid plate and the new relay rod assembly per the main suspension kit instructions.

Figure 2

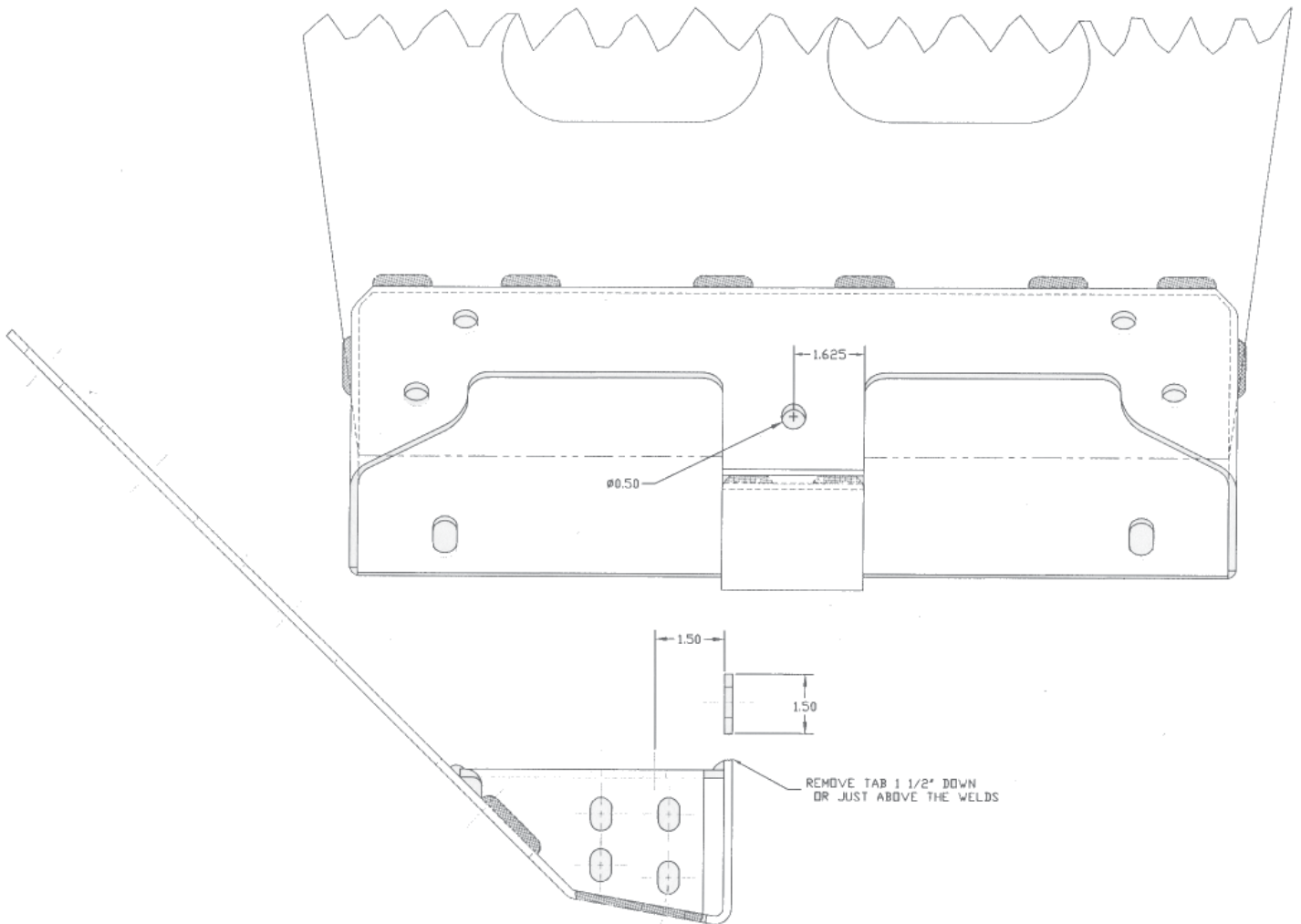

5. Assemble the center support link per Figure 3. Carefully set the link length so that the attaching bolts easily slip through both the relay rod and skid plate attachment holes. Torque the link fasteners to 80 ft. lbs.
6. Continue to follow the main suspension kit instructions through completion.

Figure 3

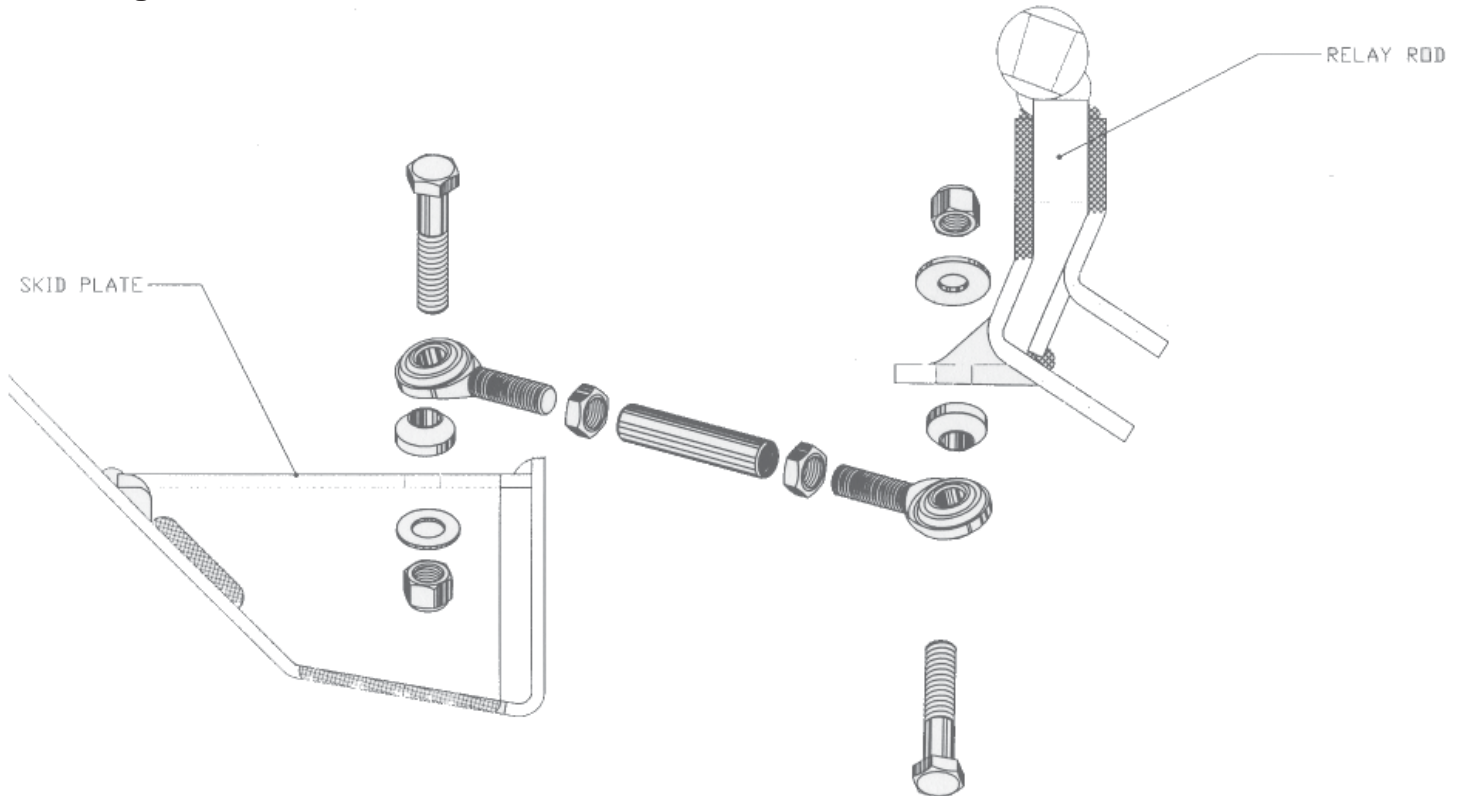

2265 Crosswind Dr., Prescott, AZ 86301
(928) 636-3175 www.p-a-g.net